

INSTALLATION MANUAL

Tools You Will Need:

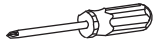

Philips Screwdriver



Adjustable wrench

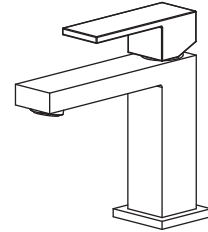

Model: AGNES Basin Mixer

Installation should comply with relevant local authority requirements.

- Maximum hot water temperature 75°C.
- Recommended minimum working pressure 150kpa.
- Recommended maximum working pressure 500kpa.

1

The hold dimension is as 35mm.

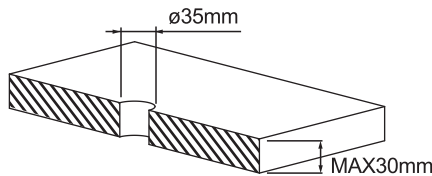

2

Turn off water supplies.
Remove the nut from the bolt.
Fix the bolt to the bottom of the tap body, tighten it by Phillips screwdriver.

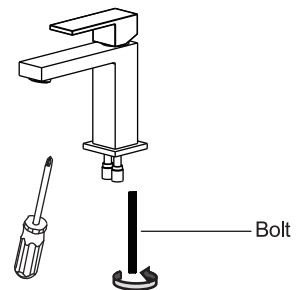

3

As shown in the figure connect two hoses to the bottom of the tap body (Notice to distinguish red & blue mark).

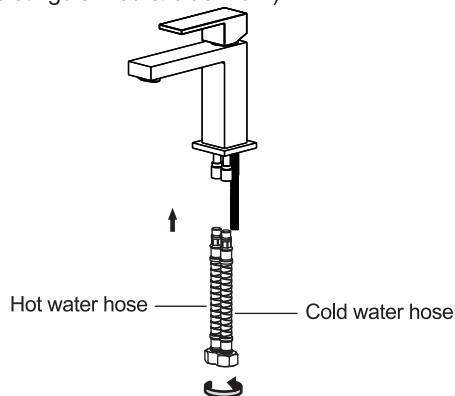

4

Insert the bolt and the hoses through the hole, ensuring the O-ring is securely placed between the bottom of the tap body and the basin.
Install the gasket and the bracket and the nut to the bolt from the underside of the basin, secure the tap with the nut.

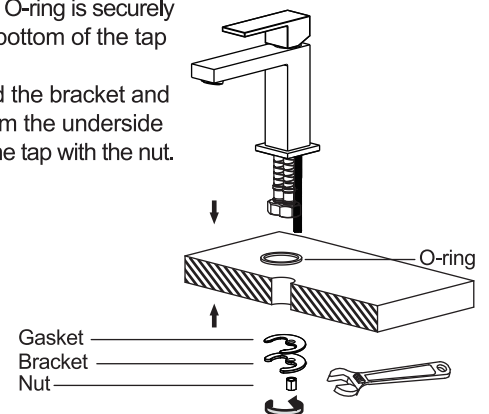

5

Attach two hoses to water supplies.
Take the aerator apart from the spout and flush the tap. Install the aerator to the tap after flushing.

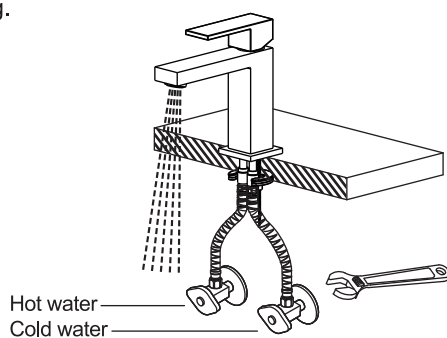

6

Mixer Operation

